

nikkoTOOLS

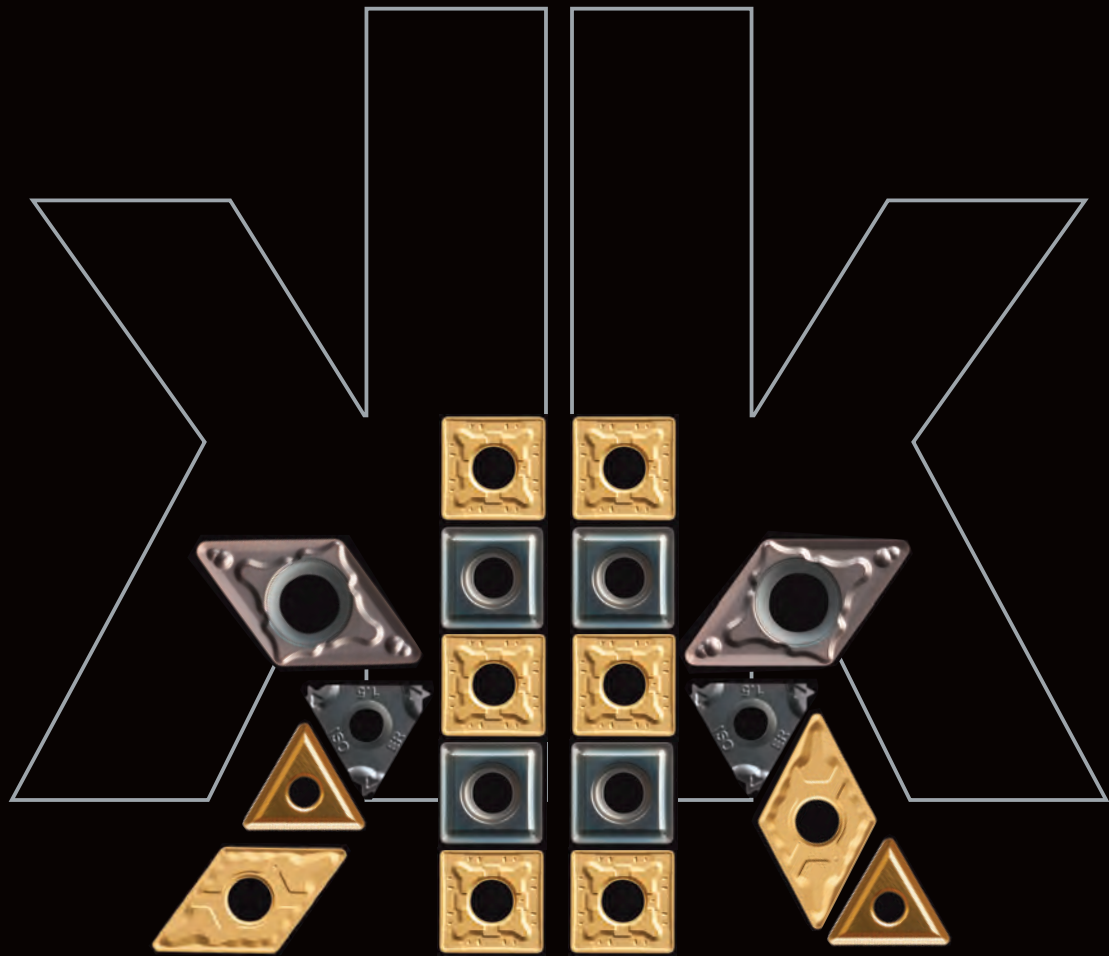

UPDATE **2019**

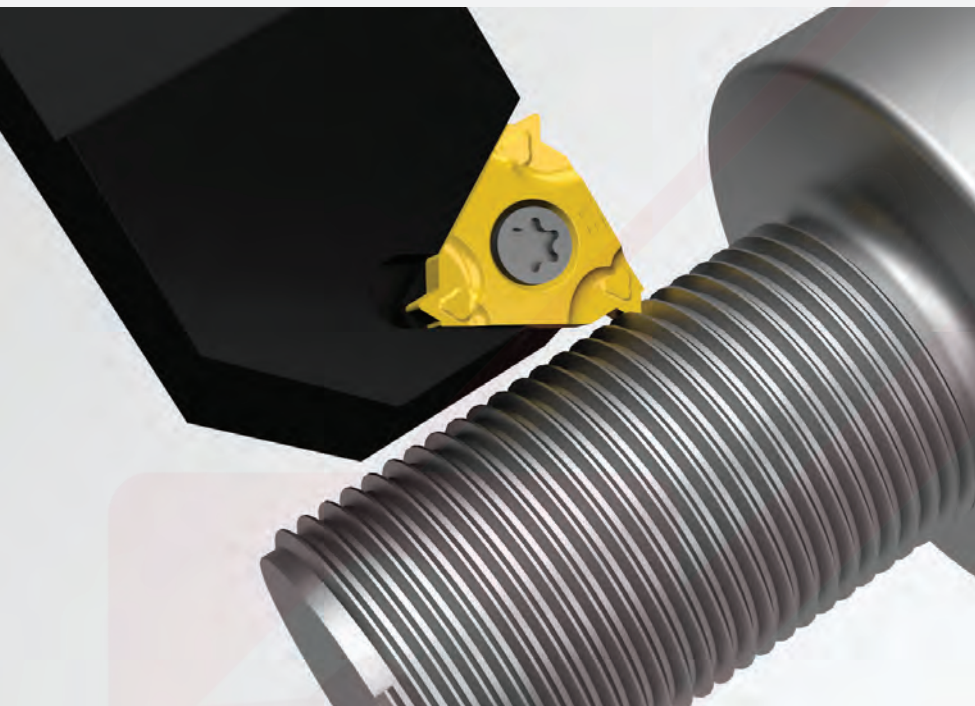

THREADING

Carbide .175
Advanced .181
Holders .185



THREADING Carbide



Depetri
OUTILLAGE

TURNING

THREADING

GROOVING





MILLING

DRILLING

ACCESSORIES

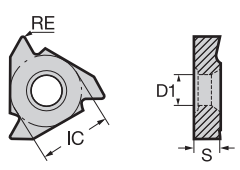
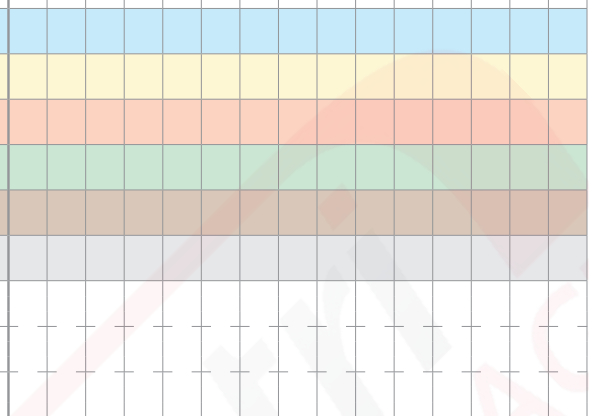
TPM	CARBIDE External threading				ISO513	HC-PVD												
	Size	IC	S	D1		JPS125												
<p>3 edges</p>	16	9.525	3.65	4.00	P	80 180												
					M	60 140												
					K	50 120												
					N													
					S	20 40												
					H													
GRADE APPLICATION AREA	Stable machining, continuous cut				+													
main application	General machining, light interruption				-													
applicable	Unstable machining, interrupted cut																	
FULL PROFILE 	16ER	100ISO-TPM	RE 0.14	pitch: 1.00 mm no. of passes 5÷8	●													
		125ISO-TPM	RE 0.18	pitch: 1.25 mm no. of passes 6÷9	●													
		150ISO-TPM	RE 0.22	pitch: 1.50 mm no. of passes 6÷9	●													
		175ISO-TPM	RE 0.25	pitch: 1.75 mm no. of passes 8÷11	●													
		200ISO-TPM	RE 0.29	pitch: 2.00 mm no. of passes 8÷11	●													
		250ISO-TPM	RE 0.36	pitch: 2.50 mm no. of passes 10÷13	●													
		300ISO-TPM	RE 0.43	pitch: 3.00 mm no. of passes 12÷15	●													
	UNIFIED 60°	16ER	24UN-TPM	RE 0.15	pitch: 24 TPI no. of passes 5÷8	●												
			20UN-TPM	RE 0.18	pitch: 20 TPI no. of passes 6÷9	●												
			18UN-TPM	RE 0.20	pitch: 18 TPI no. of passes 6÷9	●												
			16UN-TPM	RE 0.23	pitch: 16 TPI no. of passes 7÷10	●												
			14UN-TPM	RE 0.26	pitch: 14 TPI no. of passes 8÷11	●												
			12UN-TPM	RE 0.31	pitch: 12 TPI no. of passes 8÷11	●												
			08UN-TPM	RE 0.46	pitch: 8 TPI no. of passes 12÷15	●												
	NATIONAL PIPE TAPERED 60°	16ER	18NPT-TPM	RE 0.20	pitch: 18 TPI no. of passes 8÷11	●												
			14NPT-TPM	RE 0.22	pitch: 14 TPI no. of passes 10÷13	●												
			11.5NPT-TPM	RE 0.25	pitch: 11.5 TPI no. of passes 12÷15	●												
	WHITWORTH 55°	16ER	19W-TPM	RE 0.17	pitch: 19 TPI no. of passes 6÷9	●												
			14W-TPM	RE 0.24	pitch: 14 TPI no. of passes 8÷11	●												
			11W-TPM	RE 0.30	pitch: 11 TPI no. of passes 9÷12	●												
	BRITISH STANDARD PIPE TAPERED 55°	16ER	28BSPT-TPM	RE 0.11	pitch: 28 TPI no. of passes 5÷8	●												
			19BSPT-TPM	RE 0.17	pitch: 19 TPI no. of passes 6÷9	●												
			14BSPT-TPM	RE 0.24	pitch: 14 TPI no. of passes 9÷12	●												
			11BSPT-TPM	RE 0.30	pitch: 11 TPI no. of passes 12÷15	●												

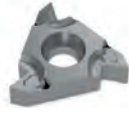
● stock standard

TPM	CARBIDE External threading				ISO513	HC-PVD											
	Size	IC	S	D1		JPS125											
 <p>3 edges</p>					P	80 180											
	16	9.525	3.65	4.00		M											60 140
						K											50 120
						N											
						S											20 40
						H											
GRADE APPLICATION AREA	Stable machining, continuous cut				+												
 main application	General machining, light interruption				-												
 applicable	Unstable machining, interrupted cut				+												
PARTIAL PROFILE  60° P M K S METRIC AND UNIFIED THREADS  55° P M K S WHITWORTH AND GAS THREADS	16ER	A60-TPM	RE 0.08	pitch: 0.50÷1.50 mm, 48÷16 TPI	●												
		G60-TPM	RE 0.25	pitch: 1.75÷3.00 mm, 14÷8 TPI	●												
		AG60-TPM	RE 0.08	pitch: 0.50÷3.00 mm, 48÷8 TPI	●												
	16ER	A55-TPM	RE 0.08	pitch: 48÷16 TPI	●												
		G55-TPM	RE 0.21	pitch: 14÷8 TPI	●												
		AG55-TPM	RE 0.08	pitch: 48÷8 TPI	●												

● stock standard



TURNING

THREADING

GROOVING

MILLING

DRILLING

ACCESSORIES

TURNING

THREADING

GROOVING

MILLING

DRILLING

ACCESSORIES

TPM	CARBIDE Internal threading				ISO513	HC-PVD																
	Size	IC	S	D1	P	JPS125																
<p>3 edges</p>	11	6.35	3.18	3.20	M	80 180																
	16	9.525	3.65	4.00	K	60 140 50 120																
					N																	
					S	20 40																
					H																	
GRADE APPLICATION AREA	Stable machining, continuous cut				+																	
main application	General machining, light interruption				-																	
applicable	Unstable machining, interrupted cut				+																	
FULL PROFILE	<p>METRIC 60°</p>	M P M K S	11IR	100ISO-TPM	RE 0.07	pitch: 1.00 mm no. of passes 5÷8	●															
		125ISO-TPM	RE 0.09	pitch: 1.25 mm no. of passes 6÷9	●																	
		150ISO-TPM	RE 0.11	pitch: 1.50 mm no. of passes 6÷9	●																	
		175ISO-TPM	RE 0.13	pitch: 1.75 mm no. of passes 8÷11	●																	
		200ISO-TPM	RE 0.15	pitch: 2.00 mm no. of passes 8÷11	●																	
		16IR	100ISO-TPM	RE 0.07	pitch: 1.00 mm no. of passes 5÷8	●																
		125ISO-TPM	RE 0.09	pitch: 1.25 mm no. of passes 6÷9	●																	
		150ISO-TPM	RE 0.11	pitch: 1.50 mm no. of passes 6÷9	●																	
		175ISO-TPM	RE 0.13	pitch: 1.75 mm no. of passes 8÷11	●																	
		200ISO-TPM	RE 0.15	pitch: 2.00 mm no. of passes 8÷11	●																	
	250ISO-TPM	RE 0.18	pitch: 2.50 mm no. of passes 10÷13	●																		
	300ISO-TPM	RE 0.22	pitch: 3.00 mm no. of passes 12÷15	●																		
	<p>UNIFIED 60°</p>	UN P M K S	16IR	24UN-TPM	RE 0.08	pitch: 24 TPI no. of passes 5÷8	●															
		20UN-TPM	RE 0.09	pitch: 20 TPI no. of passes 6÷9	●																	
		18UN-TPM	RE 0.10	pitch: 18 TPI no. of passes 6÷9	●																	
		16UN-TPM	RE 0.12	pitch: 16 TPI no. of passes 7÷10	●																	
		14UN-TPM	RE 0.13	pitch: 14 TPI no. of passes 8÷11	●																	
		12UN-TPM	RE 0.16	pitch: 12 TPI no. of passes 8÷11	●																	
		08UN-TPM	RE 0.23	pitch: 8 TPI no. of passes 12÷15	●																	
		<p>NATIONAL PIPE TAPERED 60°</p>	NPT P M K S	16IR	18NPT-TPM	RE 0.20	pitch: 18 TPI no. of passes 8÷11	●														
14NPT-TPM	RE 0.22		pitch: 14 TPI no. of passes 10÷13	●																		
11.5NPT-TPM	RE 0.25		pitch: 11.5 TPI no. of passes 12÷15	●																		
<p>WHITWORTH 55°</p>	W P M K S	16IR	19W-TPM	RE 0.17	pitch: 19 TPI no. of passes 6÷9	●																
	14W-TPM	RE 0.24	pitch: 14 TPI no. of passes 8÷11	●																		
	11W-TPM	RE 0.30	pitch: 11 TPI no. of passes 9÷12	●																		

● stock standard

TPM	CARBIDE Internal threading				ISO513	HC-PVD														
	Size	IC	S	D1		JPS125														
<p>3 edges</p>					P	80 180														
	11	6.35	3.18	3.20		M	60 140													
	16	9.525	3.65	4.00		K	50 120													
						N														
						S	20 40													
						H														
GRADE APPLICATION AREA	Stable machining, continuous cut				+															
main application	General machining, light interruption				-															
applicable	Unstable machining, interrupted cut				+															
FULL PROFILE <p>BRITISH STANDARD PIPE TAPERED 55°</p>	16IR	28BSPT-TPM	RE 0.11	pitch: 28 TPI no. of passes 5÷8	●															
		19BSPT-TPM	RE 0.17	pitch: 19 TPI no. of passes 6÷9	●															
		14BSPT-TPM	RE 0.24	pitch: 14 TPI no. of passes 9÷12	●															
		11BSPT-TPM	RE 0.30	pitch: 11 TPI no. of passes 12÷15	●															
PARTIAL PROFILE <p>METRIC AND UNIFIED THREADS</p>	11IR	A60-TPM	RE 0.08	pitch: 0.50÷1.50 mm, 48÷16 TPI	●															
	16IR	A60-TPM	RE 0.08	pitch: 0.50÷1.50 mm, 48÷16 TPI	●															
		G60-TPM	RE 0.13	pitch: 1.75÷3.00 mm, 14÷8 TPI	●															
		AG60-TPM	RE 0.08	pitch: 0.50÷3.00 mm, 48÷8 TPI	●															
<p>WHITWORTH AND GAS THREADS</p>	11IR	A55-TPM	RE 0.08	pitch: 48÷16 TPI	●															
	16IR	A55-TPM	RE 0.08	pitch: 48÷16 TPI	●															
		G55-TPM	RE 0.21	pitch: 14÷8 TPI	●															
		AG55-TPM	RE 0.08	pitch: 48÷8 TPI	●															

● stock standard

TURNING

THREADING

GROOVING

MILLING

DRILLING

ACCESSORIES



Depetri
MULTITILLAGE



THREADING Advanced

TURNING

THREADING

GROOVING

MILLING

DRILLING

ACCESSORIES

<h1>16ER</h1>	DIAMOND-PCBN External threading				ISO513	DP	BH												
	Size	IC	S	D1	P	ND120	BH												
	16	9.525	3.65	4.00	M		140	◀ SINTERED POWDER METAL											
					K		300												
					N		400												
					S		1200												
					H		500												
					H		2000												
					H		60												
					H		160												
GRADE APPLICATION AREA		Stable machining, continuous cut			+														
■ main application		General machining, light interruption			-														
■ applicable		Unstable machining, interrupted cut			+														

FULL PROFILE 	METRIC N H																			
	16ER	100ISO	N	pitch: 1.00 mm no. of passes 5÷8	○															
			H	pitch: 1.00 mm no. of passes 7÷10	○															
		125ISO	N	pitch: 1.25 mm no. of passes 6÷9	○															
			H	pitch: 1.25 mm no. of passes 8÷11	○															
		150ISO	N	pitch: 1.50 mm no. of passes 6÷9	○															
			H	pitch: 1.50 mm no. of passes 8÷11	○															
		175ISO	N	pitch: 1.75 mm no. of passes 8÷11	○															
			H	pitch: 1.75 mm no. of passes 10÷13	○															
		200ISO	N	pitch: 2.00 mm no. of passes 8÷11	○															
			H	pitch: 2.00 mm no. of passes 10÷13	○															
		250ISO	N	pitch: 2.50 mm no. of passes 10÷13	○															
			H	pitch: 2.50 mm no. of passes 13÷15	○															
		300ISO	N	pitch: 3.00 mm no. of passes 12÷15	○															
			H	pitch: 3.00 mm no. of passes 14÷17	○															

○ non-standard stock

<h1>16IR</h1>	DIAMOND-PCBN Internal threading				ISO513	DP	BH														
						ND120	NBH450U														
	Size	IC	S	D1	P	140	◀ SINTERED POWDER METAL														
	16	9.525	3.65	4.00	M	300															
					K	400															
					N	1200															
				S	500																
				H	2000																
				H	60																
				H	160																
GRADE APPLICATION AREA		Stable machining, continuous cut			+																
■ main application		General machining, light interruption			-																
■ applicable		Unstable machining, interrupted cut			+																

FULL PROFILE	METRIC N H																					
	16IR	100ISO	N	pitch: 1.00 mm no. of passes 5÷8	○																	
			H	pitch: 1.00 mm no. of passes 7÷10	○																	
	125ISO	125ISO	N	pitch: 1.25 mm no. of passes 6÷9	○																	
			H	pitch: 1.25 mm no. of passes 8÷11	○																	
	150ISO	150ISO	N	pitch: 1.50 mm no. of passes 6÷9	○																	
			H	pitch: 1.50 mm no. of passes 8÷11	○																	
	175ISO	175ISO	N	pitch: 1.75 mm no. of passes 8÷11	○																	
			H	pitch: 1.75 mm no. of passes 10÷13	○																	
	200ISO	200ISO	N	pitch: 2.00 mm no. of passes 8÷11	○																	
			H	pitch: 2.00 mm no. of passes 10÷13	○																	
	250ISO	250ISO	N	pitch: 2.50 mm no. of passes 10÷13	○																	
			H	pitch: 2.50 mm no. of passes 13÷15	○																	
	300ISO	300ISO	N	pitch: 3.00 mm no. of passes 12÷15	○																	
			H	pitch: 3.00 mm no. of passes 14÷17	○																	

○ non-standard stock

TURNING

THREADING

GROOVING

MILLING

DRILLING

ACCESSORIES

Depetri
OUTILLAGE

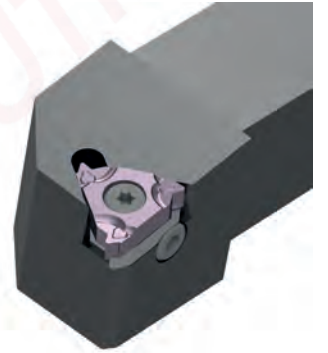

THREADING Holders



TURNING

16E

EXTERNAL

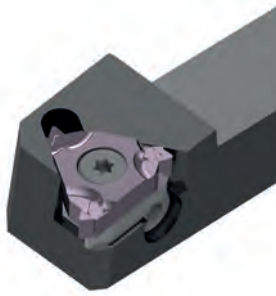
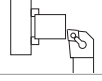

Right-hand shown



THREADING

SE N

External threading

R L

H	B	WF	LF	KG	MIID
---	---	----	----	----	------

16	NT-SE%/1212H16N	●	○	12	12	12	100	16E%/□□□□
	NT-SE%/1616H16N	○	○	16	16	16	100	

● stock standard, ○ non-standard stock

GROOVING

Spare Parts



	SHIM	SHIM SCREW	SHIM WRENCH	INSERT SCREW	INSERT WRENCH
NT-SER1212H16N	NT-SH060	NT-ST080	NT-WR025	NT-ST040	NT-FT15
NT-SER1616H16N					
NT-SEL1212H16N	NT-SH065	NT-ST080	NT-WR025	NT-ST040	NT-FT15
NT-SEL1616H16N					

MILLING

DRILLING

ACCESSORIES

16E

Right-hand shown

EXTERNAL

SE										
External threading										
		R	L	H	B	WF	LF	LH	KG	MIID

16	NT-SE%/1616H16	●	●	16	16	20	100	22		
	NT-SE%/2020K16	●	●	20	20	25	125	25		16E%□□□
	NT-SE%/2525M16	●	●	32	25	32	150	25		

● stock standard

Spare Parts	SHIM	SHIM SCREW	SHIM WRENCH	INSERT SCREW	INSERT WRENCH

NT-SER1616H16	NT-SH060	NT-ST080	NT-WR025	NT-ST040	NT-FT15
NT-SER2020K16					
NT-SER2525M16					
NT-SEL1616H16	NT-SH065	NT-ST080	NT-WR025	NT-ST040	NT-FT15
NT-SEL2020K16					
NT-SEL2525M16					



- TURNING
- THREADING
- GROOVING
- MILLING
- DRILLING
- ACCESSORIES

TURNING

111
161

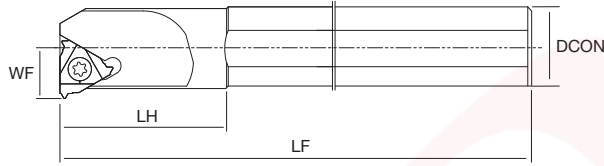
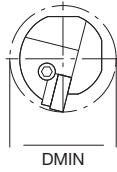
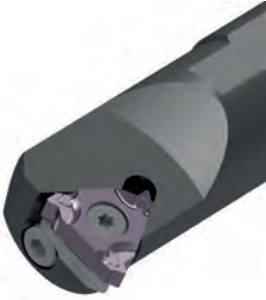

Right-hand shown

STEEL

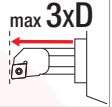

THREADING

SI

Internal threading

R L

DMIN

DCON

WF

LF

LH



MIID

		R	L	DMIN	DCON	WF	LF	LH	KG	MIID		
11	NT-SIR1012-11	●		10	12	5.2	150	25			111R□□□	
	NT-SIR1216-11*	●		12	16	6.3	150	25				
	NT-SIR1516-11*	●		15	16	7.5	150	25				
16	NT-SIP/2016-16	●	●	20	16	10	150	35			16P/L□□□	
	NT-SIP/2420S-16	●	●	24	20	12	180	35				
	NT-SIP/3025S-16	●	●	30	25	15	200	35				
	NT-SIP/3732S-16	●	●	37	32	18.5	250	35				

● stock standard

*Reduced neck

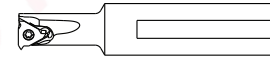

GROOVING

Spare Parts	SHIM	SHIM SCREW	SHIM WRENCH	INSERT SCREW	INSERT WRENCH

MILLING



NT-SIR1012-11					
NT-SIR1216-11	-	-	-	NT-ST041	NT-FT08
NT-SIR1516-11					
NT-SIR2016-16	-	-	-	NT-ST030	
NT-SIR2420S-16					NT-FT15
NT-SIR3025S-16	NT-SH065	NT-ST080	NT-WR025	NT-ST040	
NT-SIR3732S-16					
NT-SIL2016-16	-	-	-	NT-ST030	
NT-SIL2420S-16					NT-FT15
NT-SIL3025S-16	NT-SH060	NT-ST080	NT-WR025	NT-ST040	
NT-SIL3732S-16					

DRILLING

ACCESSORIES

111
161

INTERNAL



Right-hand shown



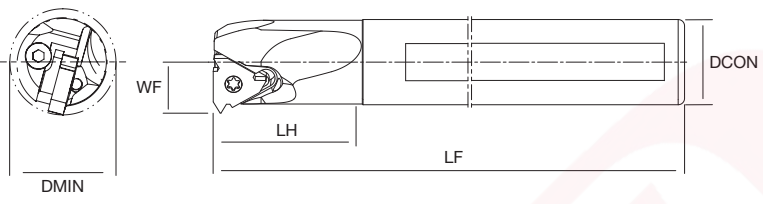

max 5xD



INTERNAL COOLANT



V SIR
Internal threading

			DMIN	DCON	WF	LF	LH	KG	MIID
--	--	--	------	------	----	----	----	----	------

11	NT-V10M-SIR11-10	●	10	10	5.2	150	25		11IR000
	NT-V16M-SIR11-12*	●	12	16	6.3	150	25		
	NT-V16M-SIR11-15*	●	15	16	7.5	150	25		
16	NT-V16M-SIR16-20	●	20	16	10	150	35		16IR000
	NT-V20Q-SIR16-24	●	24	20	12	180	35		
	NT-V25R-SIR16-30	●	30	25	15	200	35		
	NT-V32S-SIR16-37	●	37	32	18.5	250	35		

● stock standard

*Reduced neck

Spare Parts	SHIM	SHIM SCREW	SHIM WRENCH	INSERT SCREW	INSERT WRENCH
NT-V10M-SIR11-10					

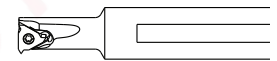

NT-V10M-SIR11-10				NT-ST041	NT-FT08
NT-V16M-SIR11-12	-	-	-		
NT-V16M-SIR11-15				NT-ST030	
NT-V16M-SIR16-20					
NT-V20Q-SIR16-24					
NT-V25R-SIR16-30	NT-SH065	NT-ST080	NT-WR025	NT-ST040	NT-FT15
NT-V32S-SIR16-37					

TURNING

THREADING

GROOVING

MILLING

DRILLING

ACCESSORIES



Via Don F. Tosatto, 8
30174 Mestre - Venezia
+39 041.959179

info@nikkotools.com
www.nikkotools.com



nikkotools